

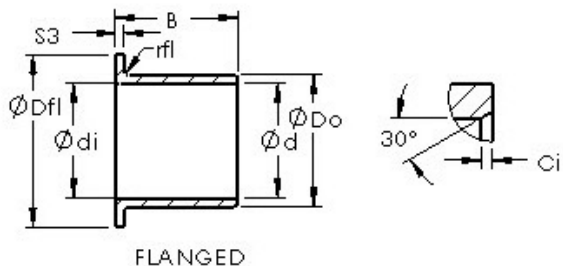

AST ASTEPBF 3539-16 plain bearings



Bearing No. ASTEPBF 3539-16

Bore Diameter	38 mm
Outer Diameter	42 mm
Bearing Type	flanged
Shaft Dia., Nominal (d)	38.0000
Bearing Outside Diameter, Nominal(Do)	42.000
Bearing Bore after Mounting (di) - 38.15	38.05
Bearing Length, Nominal (B)	16.000
OD Chamfer Length (Co)	1.200
Flange Dia. (Dfl pm 0.5)	54.000
Flange Thickness (Sfl)	2.000
Material	Molded plastic with self lubricating resins.

ASTEPBF 3539-16 Bearing 2D drawings and 3D CAD models